

Gear Pump **ISO BI-DIRECTIONAL**

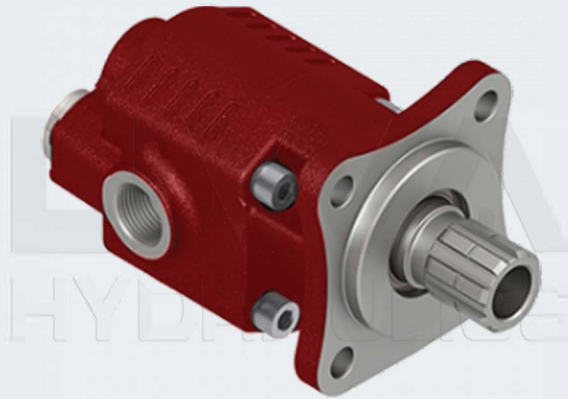

Available Shaft Types

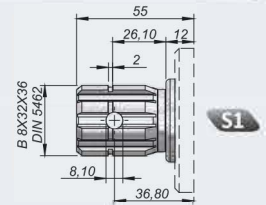

Product Code	Displacement (cm ³ / rev)	Max.Cont. Pressure (100%)(bar)	Max.Peak Pressure (6 sec.max.)(bar)	Max.Cont. Speed (rpm)	Inlet	Outlet
20/ISO Bi-Directional						
22149006	6	280	330	2300	G1/2"	G1/2"
22149010	10					
22149016	16					
22149020	20	260	300	2100	G3/4"	G3/4"
22149025	25	220	270			
22149032	32	190	220	1900		
22149040	40	180	200			

Gear Pump **UNI BI-DIRECTIONAL**

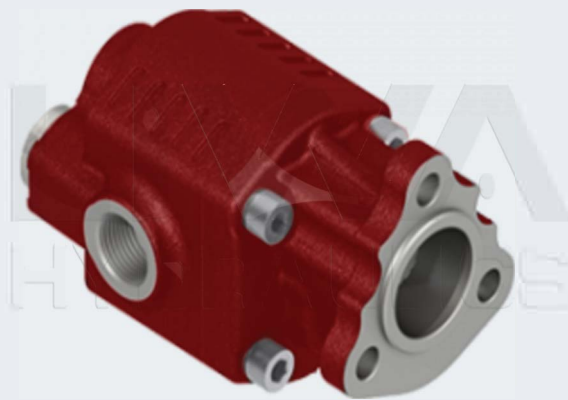

Available Shaft Types

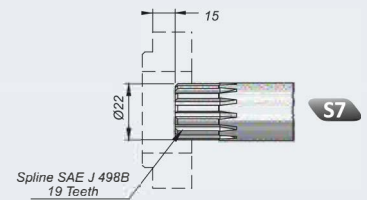

Product Code	Displacement (cm ³ / rev)	Max.Cont. Pressure (100%)(bar)	Max.Peak Pressure (6 sec.max.)(bar)	Max.Cont. Speed (rpm)	Inlet	Outlet
20/UNI Bi-Directional						
22139006	6	280	330	2300	G1/2"	G1/2"
22139010	10					
22149016	16					
22139020	20	260	300	2100	G3/4"	G3/4"
22139025	25	220	270			
22139032	32	190	220	1900		
22139040	40	180	200			

Gear Pump **K TYPE BI-DIRECTIONAL**



Available Shaft Types

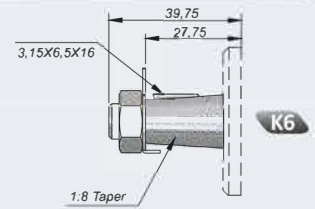

Product Code	Displacement (cm ³ / rev)	Max.Cont. Pressure (100%)(bar)	Max.Peak Pressure (6 sec.max.)(bar)	Max.Cont. Speed (rpm)	Inlet	Outlet
20/K TYPE Bi-Directional						
22159006	6	280	330	2300	G1/2"	G1/2"
22159010	10					
22159016	16					
22159020	20	260	300	2100	G3/4"	G3/4"
22159025	25	220	270			
22159032	32	190	220	2100	G3/4"	G3/4"
22159040	40	180	200	1900		