

HYDRAULIC KITS HYDRAULIC COMPLETE KITS 12 m3 - 99112722

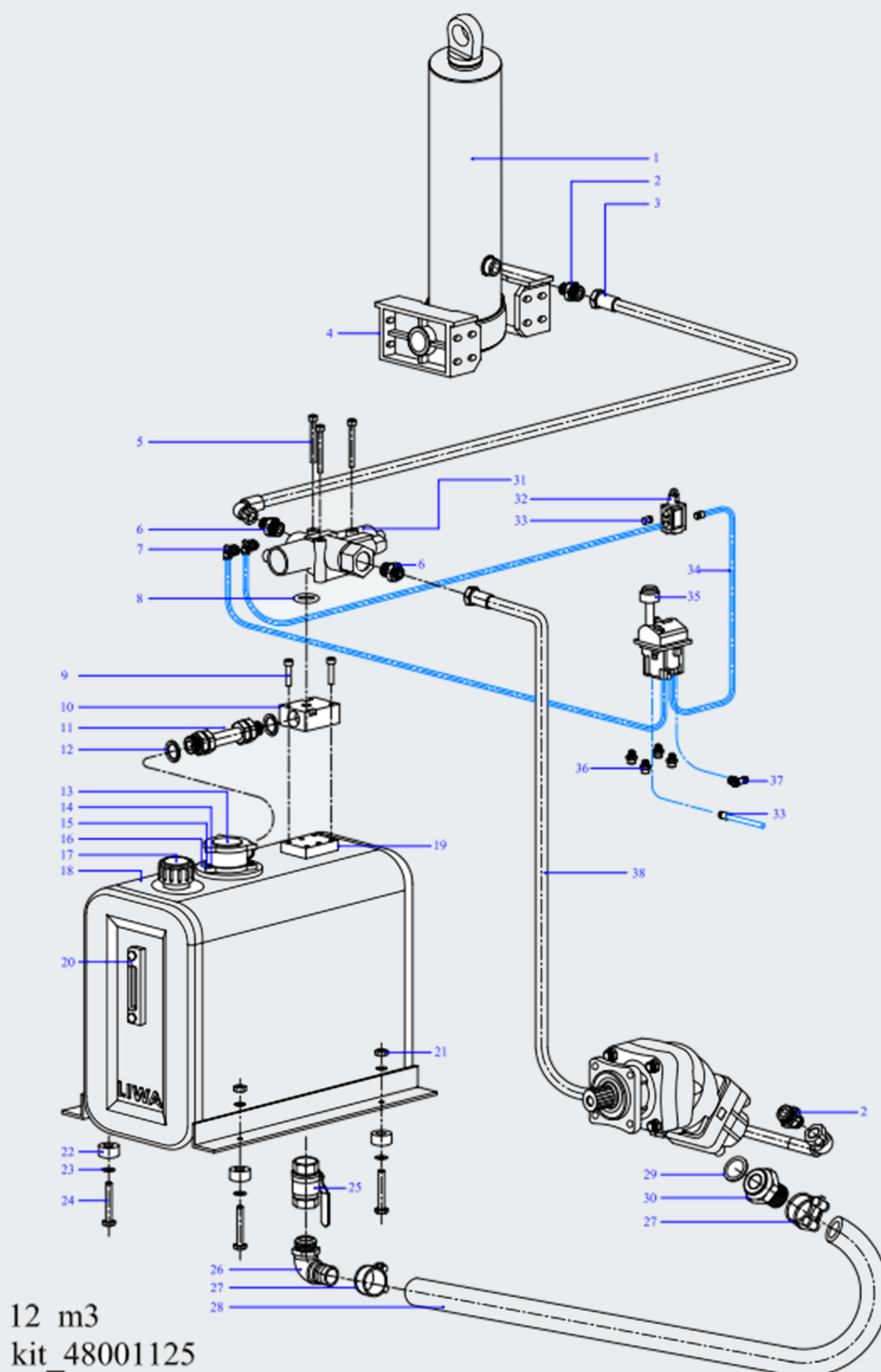

| HYDRAULIC KIT CODE: 99112722 | | |
|------------------------------|----------|---------------------------|
| 12 m3 HYDRAULIC KIT | | |
| P.NO | QUANTITY | DESCRIPTION OF PRODUCT |
| 1 | 1 | TELESCOPIC CYLINDER |
| 2 | 2 | FITTING |
| 3 | 1 | PRESSURE HOSE |
| 4 | 1 | CYLINDER BRACKET KIT |
| 5 | 3 | BOLT FOR VALVE MOUNT |
| 6 | 3 | FITTING |
| 7 | 2 | AIR FITTING ELBOW 1/8 |
| 8 | 1 | WASHER WITH SEAL |
| 9 | 2 | BOLT FOR VALVE PLATE |
| 10 | 1 | VALVE PLATE |
| 11 | 1 | FILTER CONNECTION |
| 12 | 2 | WASHER WITH SEAL |
| 13 | 1 | RETURN FILTER |
| 14 | 2 | BOLT |
| 15 | 2 | BOLT WASHER |
| 16 | 1 | FILTER FLANGE |
| 17 | 1 | FILLER CAP |
| 18 | 1 | OIL TANK |
| 19 | 1 | SUB PLATE |
| 20 | 1 | OIL INDICATOR |
| 21 | 4 | FIBER NUT |
| 22 | 4 | TANK RUBBER |
| 23 | 4 | WASHER |
| 24 | 4 | BOLT |
| 25 | 1 | BALL VALVE |
| 26 | 2 | HOSE PILLAR ELBOW 90 |
| 27 | 2 | HOSE CLIPS |
| 28 | 1 | SUCTION HOSE |
| 29 | 1 | WASHER WITH SEAL |
| 30 | 1 | INLET FITTING |
| 31 | 1 | TIPPING VALVE |
| 32 | 1 | LIMIT CONTROL VALVE |
| 33 | 2 | AIR FITTING STRAIGHT 1/4 |
| 34 | 1 | AIR HOSE |
| 35 | 1 | PNEUMATIC TIPPING CONTROL |
| 36 | 4 | AIR FITTING STRAIGHT 1/8 |
| 37 | 1 | AIR FITTING "T" |
| 38 | 1 | PRESSURE HOSE |
| 39 | 1 | BENT AXIS PISTON PUMP |